

KITTITAS CO CDS  
RECEIVED  
04/21/2023

1041 WAPITI DRIVE  
A PORTION OF THE SW 1/4 OF SECTION 22, T. 20 N., R. 14 E., W.M.  
KITTITAS COUNTY, STATE OF WASHINGTON

20' 0 10' 20'  
SCALE: 1" = 20'



BOOK 8 OF SURVEYS,  
PAGES 72-75

ELK MEADOWS PARK NO. 2  
BOOK 5 OF PLATS,  
PAGES 27 & 28

ELK MEADOWS PARK  
BOOK 4 OF PLATS,  
PAGES 57-59

APN 290534  
BOOK 44 OF SURVEYS,  
PAGE 94  
±0.44 ACRES

BLOCK B

15

NOTES:

- THE PURPOSE OF THIS SURVEY IS TO IDENTIFY THE BOUNDARY LINES AND BUILDING SETBACKS ON THE EAST HALF OF LOT 16, BLOCK B, ELK MEADOWS PARK PLAT.
- THIS SURVEY WAS PERFORMED USING A TRIMBLE R10 GNSS AND A TRIMBLE S7, 3" TOTAL STATION WITH ACCURACY THAT MEETS OR EXCEEDS WAC 332-130-090.
- THIS SURVEY DOES NOT PURPORT TO SHOW ALL EASEMENTS, ENCUMBRANCES OR RESTRICTIONS OF RECORD OR OTHERWISE.
- FOR ADDITIONAL SURVEY AND REFERENCE INFORMATION, SEE THE FOLLOWING:
  - BOOK 4 OF PLATS, PAGES 57-59, APN: 348626
  - BOOK 5 OF PLATS, PAGES 27 & 28, APN: 355257
  - BOOK 18 OF SURVEYS, PAGES 154-156, APN: 547723
  - BOOK 41 OF SURVEYS, PAGE 154, APN: 20180626040
  - BOOK 44 OF SURVEYS, PAGE 94, APN: 202112010077AND THE SURVEYS REFERENCED THEREON, RECORDS OF KITTITAS COUNTY, STATE OF WASHINGTON.
- THE FIELD WORK FOR THIS SURVEY WAS COMPLETED ON DECEMBER 7, 2022.

EXISTING LEGAL DESCRIPTION PER STATUTORY WARRANT DEED - AUDITOR'S FILE NUMBER 202105040072:

THE EAST HALF OF LOT 16, BLOCK "B", ELK MEADOWS PARK, IN THE COUNTY OF KITTITAS, STATE OF WASHINGTON, AS PER PLAT THEREOF RECORDED IN BOOK 4 OF PLATS, PAGES 57, 58 AND 59, RECORDS OF SAID COUNTY.

PARCEL INFORMATION:

PARCEL NO. MAP NO.  
290534 20-14-22050-0224

ADDRESS:

1041 WAPITI DRIVE  
CLE ELUM, WA 98922

FLOODPLAIN INFORMATION:

- PORTIONS OF THIS PROPERTY LIE WITHIN THE REGULATORY FLOODPLAIN AND FLOODWAY.
- THE BASE FLOOD ELEVATION (BFE) IS 2047.2'.

SETBACK INFORMATION:

- THE BUILDING SETBACKS SHOWN HEREON ARE PER KITTITAS COUNTY ZONING CODE 17.30A.050.
- THE SETBACK TO THE ORDINARY HIGH WATER MARK (OHWM) SHOWN HEREON WAS ESTABLISHED 115 FEET FROM THE LOCATION OF A MARK PLACED BY OTHERS APPROXIMATELY 4 FEET SOUTH OF THE TOP OF BANK ON THE YAKIMA RIVER.

LEGEND

- FOUND 5/8" IRON ROD & CAP, LS 45503, UNLESS OTHERWISE NOTED  
○<sup>IR</sup> FOUND IRON ROD, NO CAP  
APN ASSESSOR'S PARCEL NUMBER

INDEX LOCATION  
SEC. 22 T. 20 N.R. 14 E.W.M.

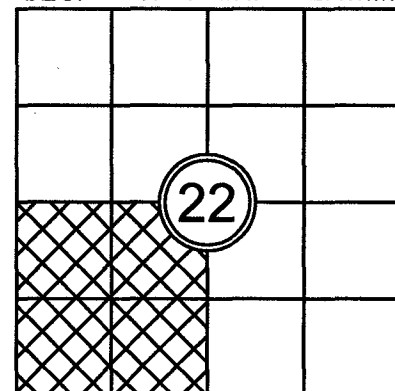

**Compass**  
ENGINEERING & SURVEYING  
Western Washington Division  
165 NE Juniper Street, Suite 201 • WA 98027 • Phone: (425) 397-0250  
Eastern Washington Division  
407 Southwest Blvd. • Cle Elum, WA 98922 • Phone: (509) 674-7433

JOB NO. 21154  
DATE 1/2/2023  
SCALE 1"=20'  
DESIGNED N/A  
DRAWN G.W.  
CHECKED D.L.P.  
APPROVED D.L.P.

SHEET 1 of 1

SAM JARAWAN

TOPOGRAPHIC SURVEY

REVISIONS

DESCRIPTION	BY	DATE
ADD DIMS TO ESBL, ADD SYMBOL, OHWM, STK, DP	DP	1/2/2023

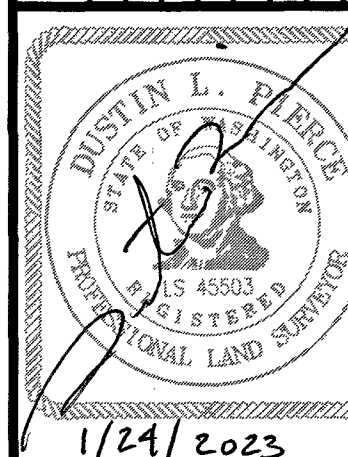

1/21/2023

THE PLANS SET FORTH ON THIS SHEET ARE AND SHALL REMAIN THE PROPERTY OF COMPASS ENGINEERING & SURVEYING.